

Your HandiTreads packaging includes installation screws.

You will need these tools to complete the installation:

- Tape measure
- Power drill or screw driver



There are 3 steps included in the proper installation of HandiTreads nosings on wood. The process is the same if you are installing one nosing or one hundred. If you find that you have any questions, don't hesitate to call us.

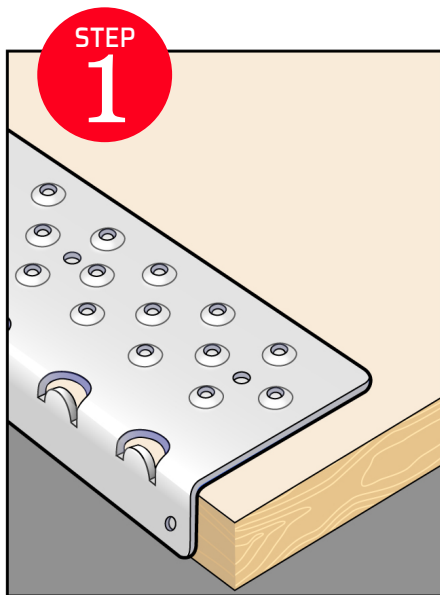

Align the nosing against the front edge of the stair. If installing multiple nosings on one step, use the measuring tape to help position side-to-side in the center of the width of your stairs or the area with the most high-traffic.

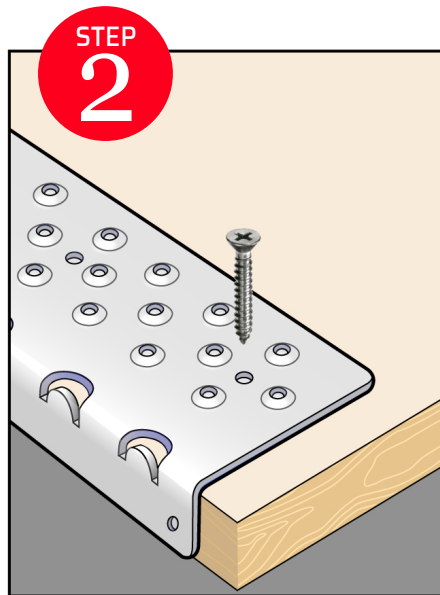

Starting with the middle screw holes, drill your screws into the stair working your way out from the center. Make sure that you are drilling perpendicular to the surface and that you use all of the screw holes provided. **DO NOT** use the raised traction bumps for your screw placement.

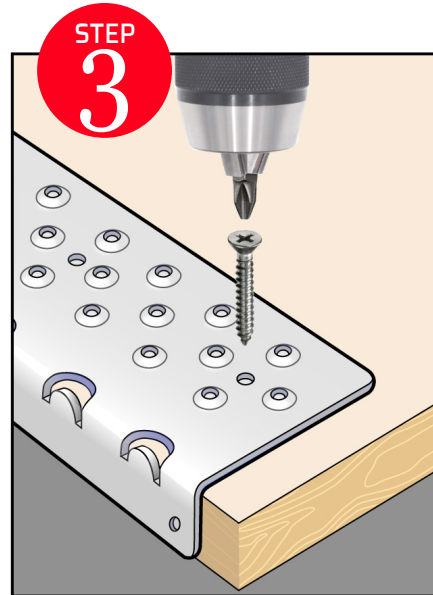

Installation is complete once all screws have been drilled into place. There's no additional maintenance necessary.

Installing the HandiTreads nosings is just that simple.

Should you have any questions, please call us at (847) 680-7700.

handitreads.com is full of useful tips to install your nosings